

SEAL-LOCK® HC (SLHC)

Connection Technology | Threaded and Coupled

Features

- Available in sizes 4-½ in. to 13-5/8 in.
- Hooked thread design allows deep stab and quick make up within 5 turns, reduced risk of cross threading
- Superior bending and torque resistance necessary for highly deviated well designs
- Dope relief groove to prevent hydraulic entrapment
- All weights of a given OD size are interchangeable
- Stresses are minimized for superior performance in sour environments

Benefits

- Metal-to-metal seal for gas tight applications
- Hooked thread design virtually eliminates jump-out

SEAL-LOCK HC is a threaded and coupled non-upset connection designed for light- to mid-weight tubulars.

The connection geometry allows multiple make and breaks, and virtually eliminates cross threading. Connection stresses are minimized to provide superior performance in H₂S and CO₂ environments. Time-proven design is optimized to meet or exceed pipe body burst ratings, formation collapse loads and to provide superior tensile strength.

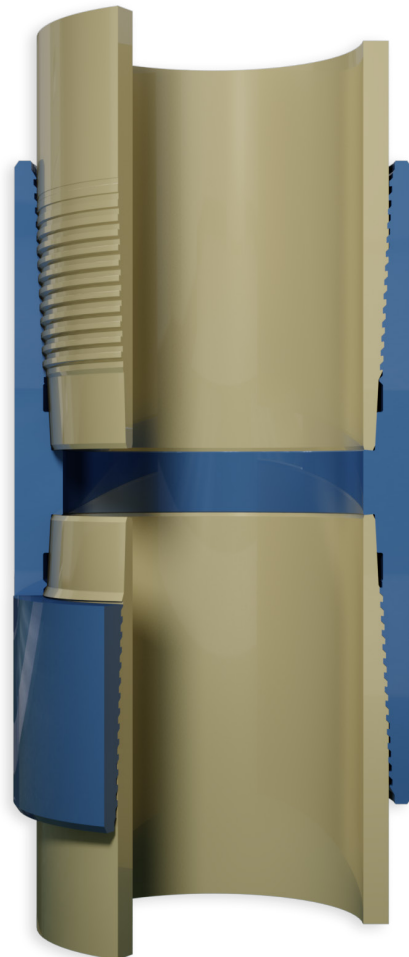

4½" – 10¾"

Hooked thread designs



11¼" – 13⁵/₈"

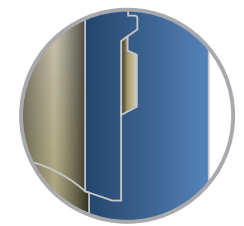

Internal trapped torque shoulder, metal-to-metal seal and lubricant reservoir